



FRENCH CLEAT POCKET HOLE DRILL CHARGING STATION

Copyright © 2014 JaysCustomCreations.com



Shopping List

Item	Quantity	Description
48"x48"x3/4" plywood	1	Sides, shelves, and french cleat
28"x48"x1/4" plywood	1	Back panel
1-1/4" pocket hole screws	31	For attaching the interior pieces to the sides
1-1/4" screws	4	For attaching the French cleat
Brad nails	Handful	To attach the back panel
Power strip	1	To power the chargers

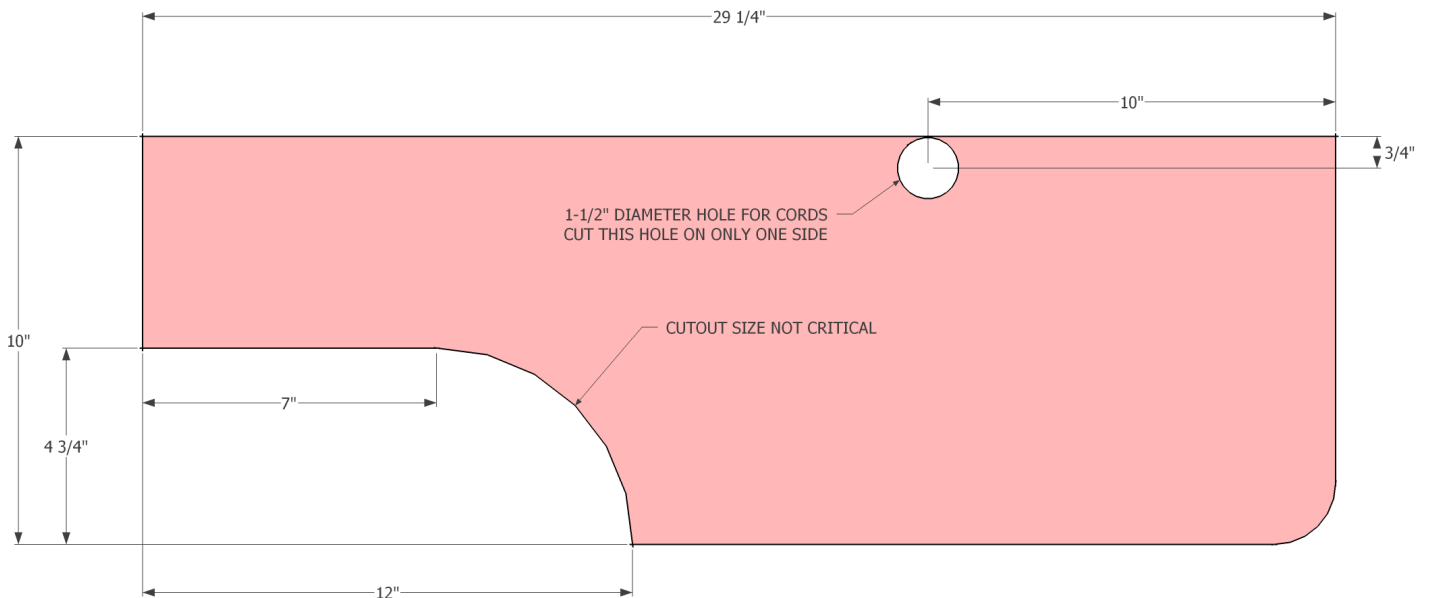
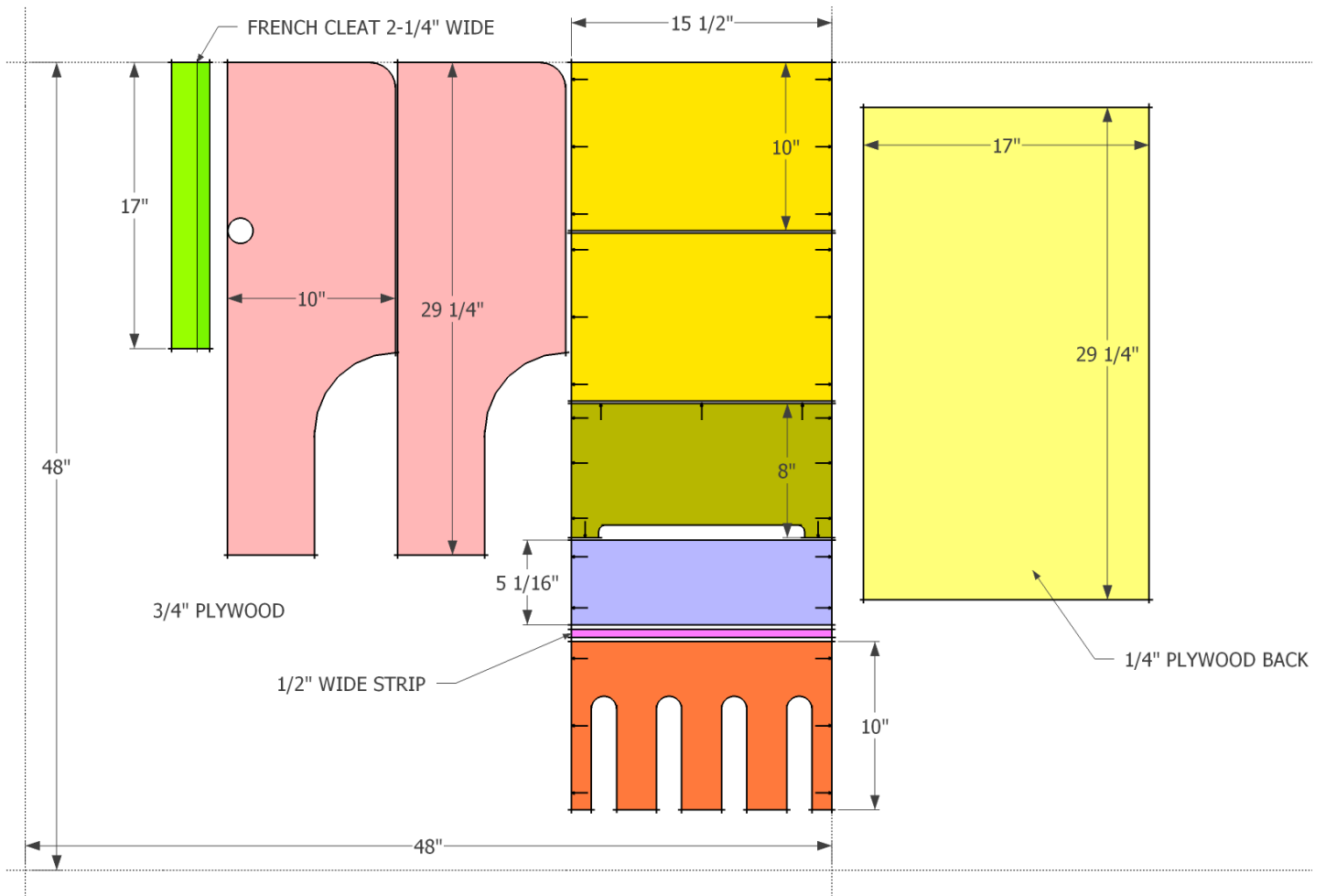

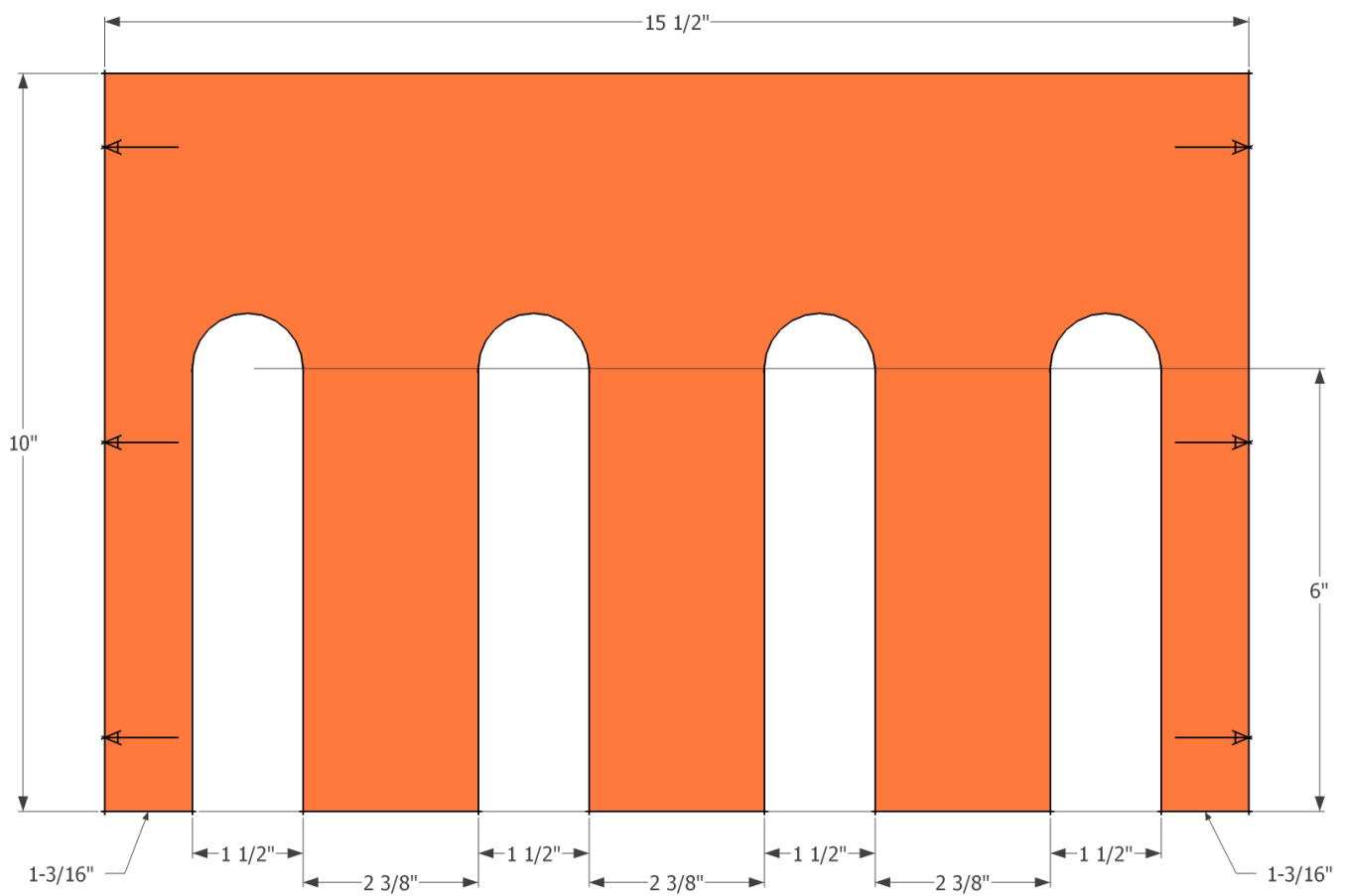
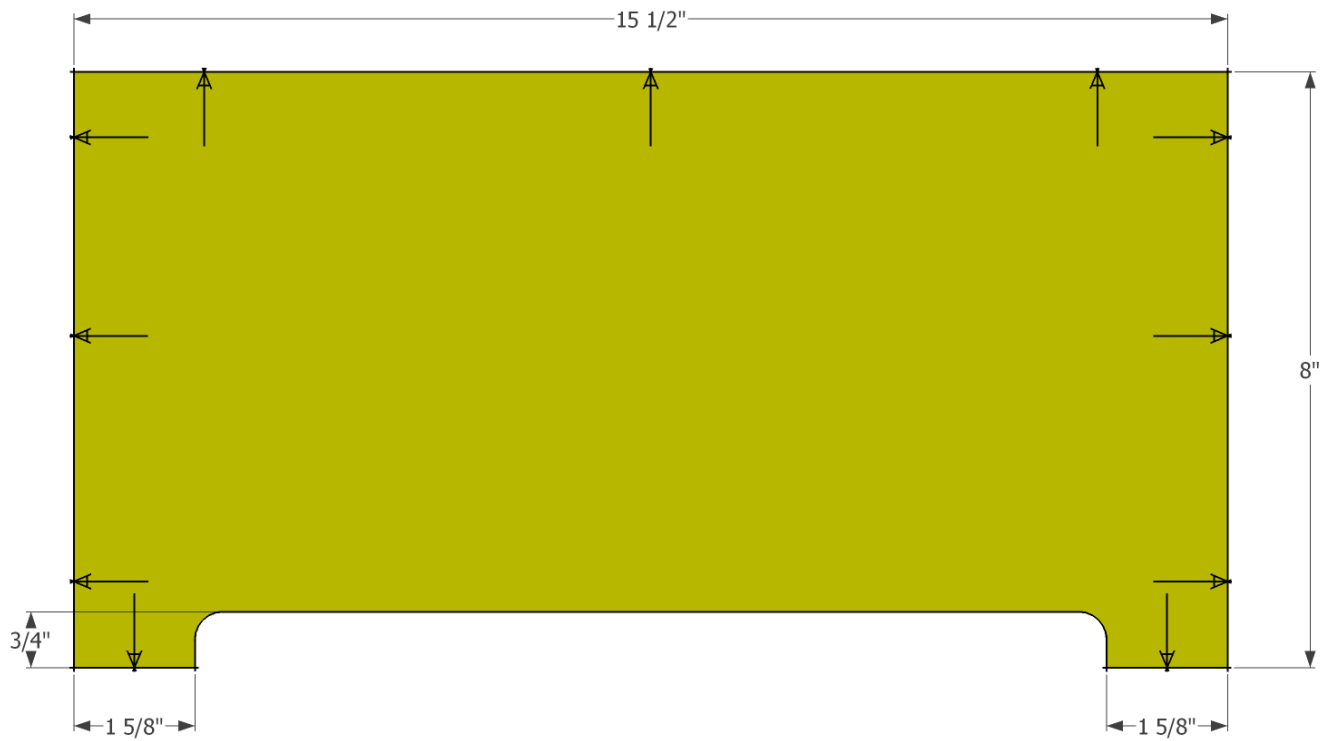

Cut

Cut all of your pieces according to the layout diagrams.

Pocket Holes

Drill pocket holes in all of your interior pieces as indicated by arrows in the diagrams.

Layout

I find it to be a big help to mark the side pieces where everything will connect to it. This will help in assembly as you do not have to measure out the location while trying to hold it together. Just line everything up with your layout lines.

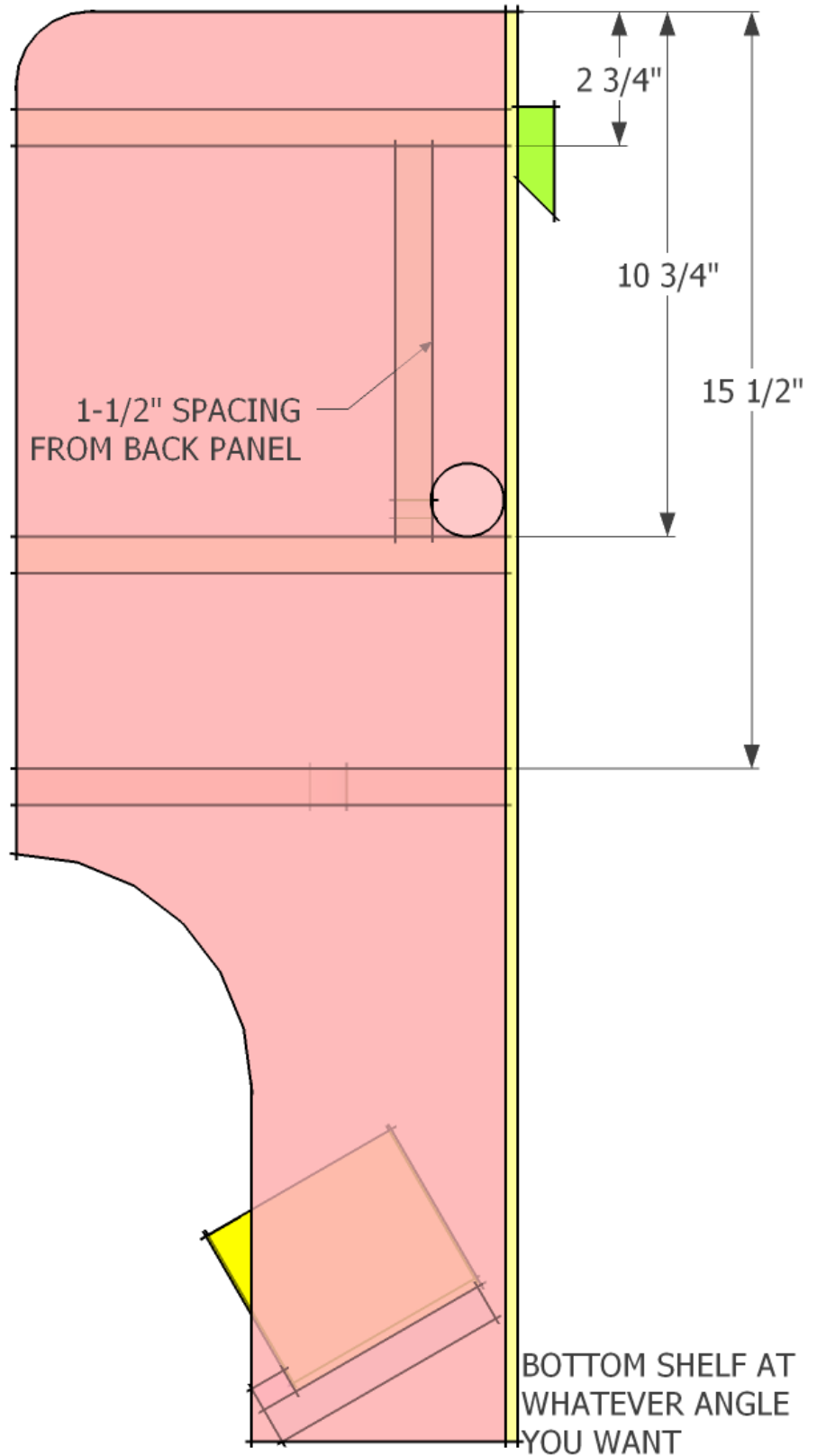

Assembly

Start with the two side pieces laying on their back and attach the top shelf.

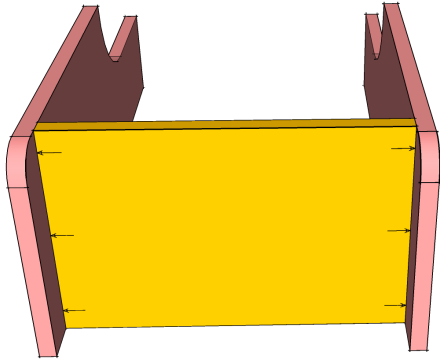

Flip the assembly on its top and attach the cord hiding divider.

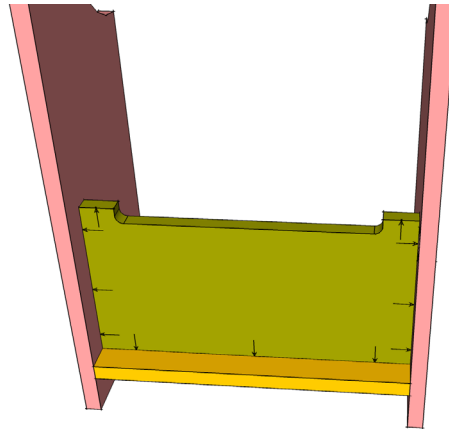

With it still in the same position attach the charger shelf.

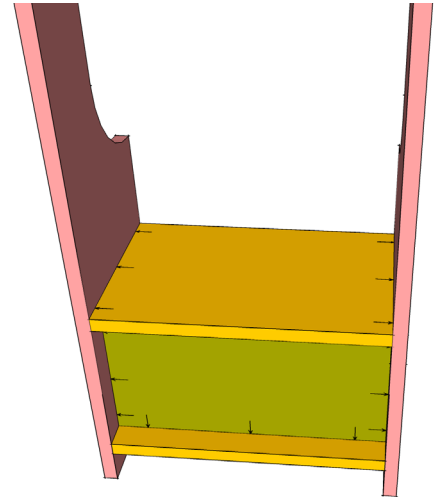

Lay the assembly on its front and attach the drill shelf and the lower angled shelf. I just eyeballed the lower angled shelf to whatever looked appropriate. If I were to guess I would say I have mine around 25-30 degrees.

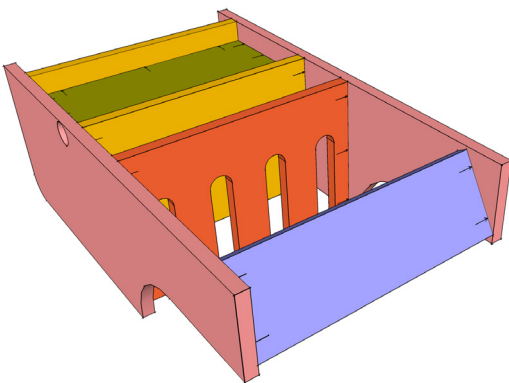

Tack on the 1/2" strip to the angled shelf.

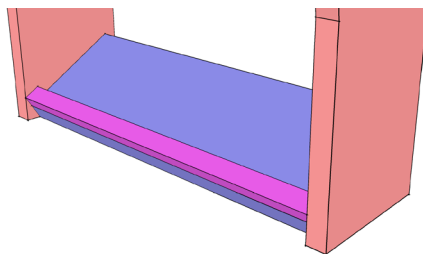

Attach the back with brad nails and screw on the cleat. Attach a power strip to the side below the 1-1/2" access hole.

