



FRENCH CLEAT BLADE STORAGE

Copyright © 2014 JaysCustomCreations.com



Shopping List

Item	Quantity	Description
24"x48"x3/4" plywood	1	Sides, shelves, and french cleat
48"x48"x1/4" plywood	1	Back panel and dividers
1-1/4" screws	18	For attaching shelves to sides and french cleat to the back
Wood glue		
Brad nails	Handful	To attach the back panel

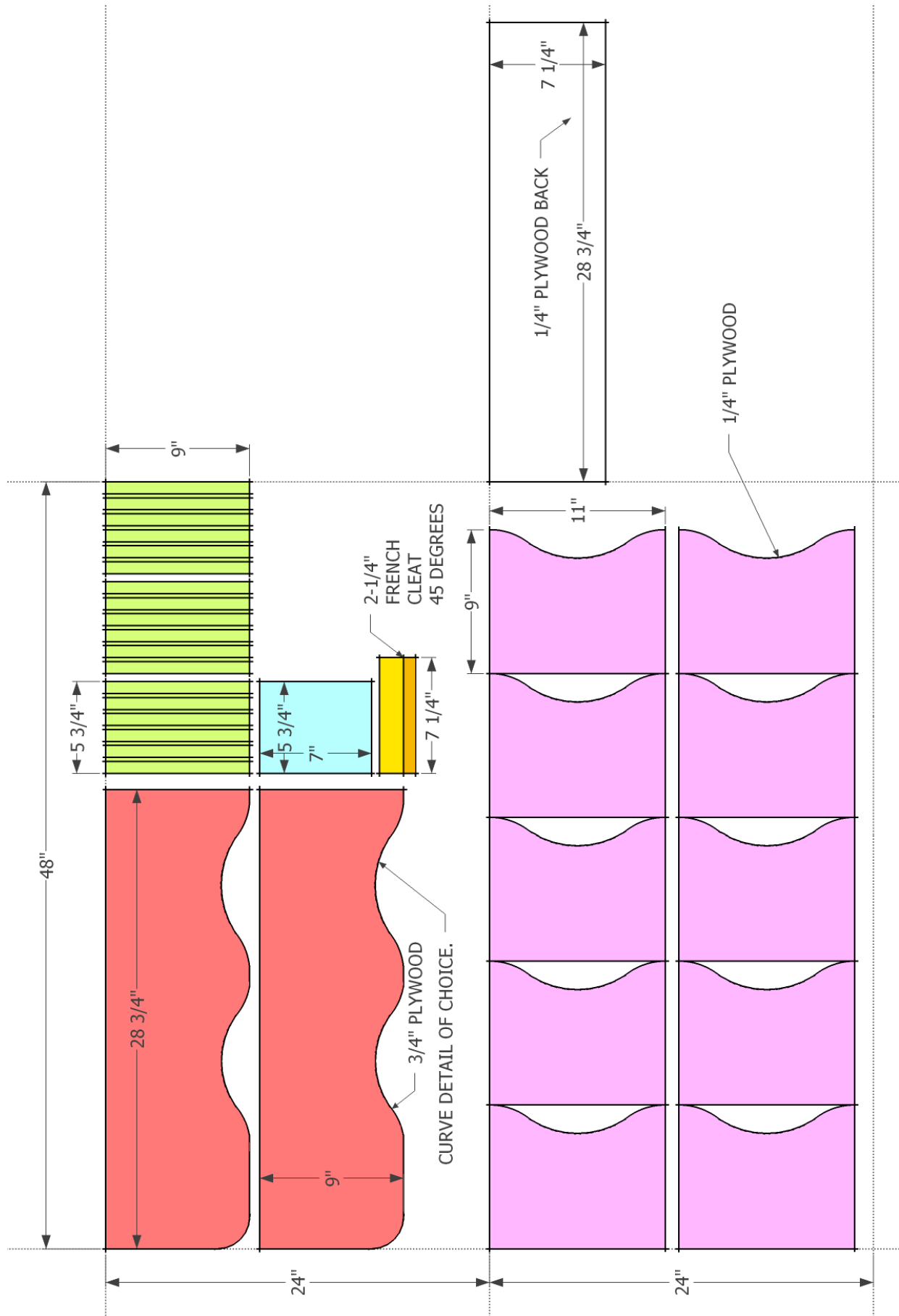

Cut

Cut all of your pieces according to the layout diagram minus the curves. The curves are optional and will be cut later.

Dados

Cut dados in the top bottom and middle pieces for the blade storage dividers. Feel free to modify the dimensions and spacing with these. I just went with an easy $\frac{3}{4}$ " opening.

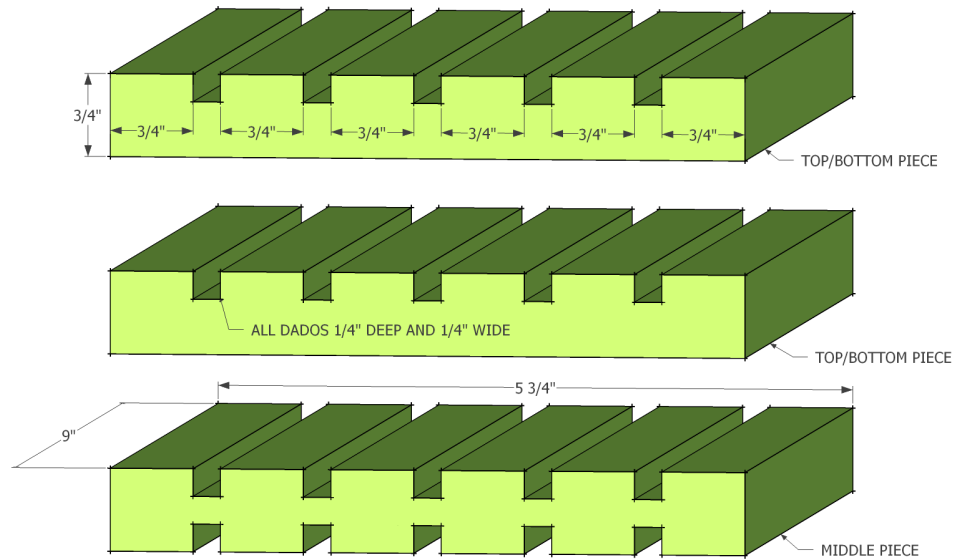

Curves

Now is the time to cut all of the curves in the sides and divider panels if you want. I recommend using some of the scrap $\frac{1}{4}$ " plywood to make a template. When making templates such as this I find it easier to reference everything off of the center line. The exact dimensions of the curve is not important. When making mine I just wanted both sides of the curve to be symmetrical and the top and bottom storage area curves to match. Once a template is made you can use it and a flush trim bit in a router to match all of the curves in the blade storage area very easily.

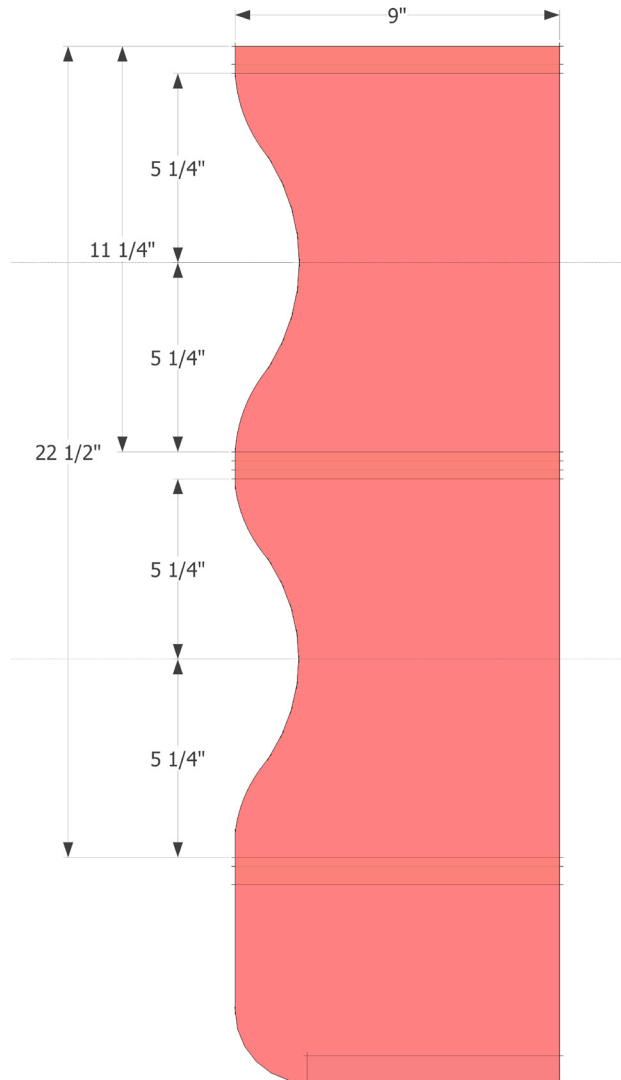

Assembly

Attach the horizontal pieces to the sides with glue and screws. Use two screws per piece at each side. It may be beneficial to pre-drill these holes to prevent splitting.

Add the back with glue and nails. Attach the cleat with glue and two screws. One screw on each end to go into the side pieces. Pre-drill these holes to prevent splitting.

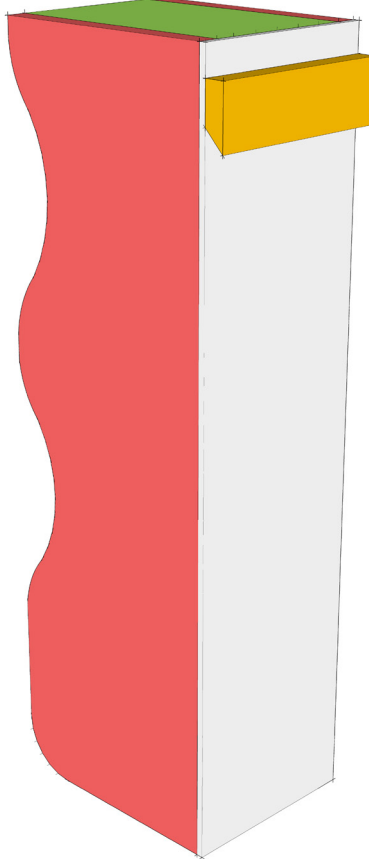
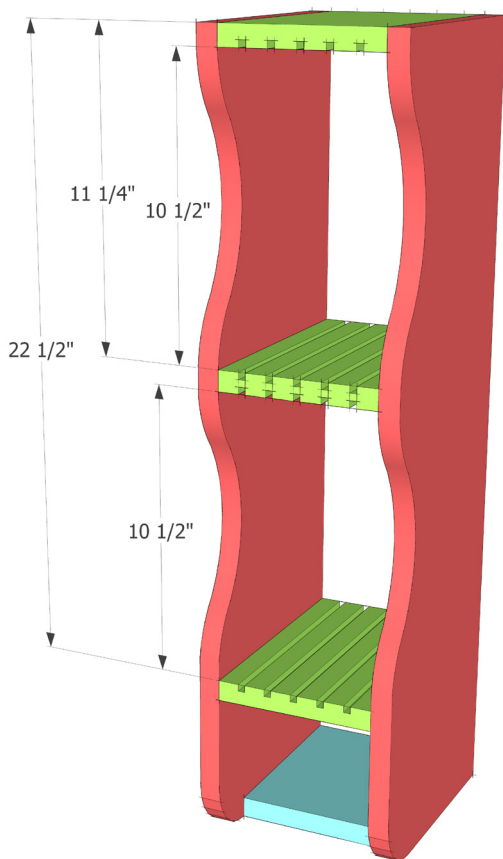

Final touches

Hang it on the wall and fill it up. You can very easily add dowels or screws to the outside for additional saw blade or other miscellaneous tool storage.

